



architecture

building for the future...

H2M's Architecture is about balance: the balance between form and function, between creative and practical, and between the built and natural environment. H2M's cooperative approach to architecture means that our design teams are both grounded and progressive, and that our designs are both attainable and sustainable. Through collaboration, peer critiques, and design mentorship, we apply best practices to meet the current and future needs of our clients and communities.



historic restoration



urban design



new construction



additions



interior architecture



adaptive reuse



renovations



integrated sustainable design



modular design

services include

- 3D Modeling
- Accessibility Assessments + Design
- Building Assessments
- Code Analysis/Assessments
- Construction Administration
- Construction Documents
- Cost Estimating
- Energy Audits
- Environmental
- Feasibility Studies
- Inspection
- LEED Services
- Permitting
- Planning
- Post Occupancy Audits
- Pre-Bond Planning
- Programming
- Public Presentations
- Rendering

Related Services:

- Structural engineering
- Mechanical
- Electrical
- Plumbing
- Fire Protection
- Civil

H2M is a multi-disciplinary professional consulting and design firm, proud of our long history of client service and our consistent ability to meet tough architectural, engineering, and environmental challenges head-on. Since 1933, H2M has helped design and build many of our local communities; from water treatment facilities to firehouses; schools to road reconstruction; and environmental site assessment to groundwater remediation. Since our early roots, our focus has remained steadfast: to provide quality service with sound judgment and to serve our clients as an honest and professional resource.

We offer a practical approach with creative results.



construction services



energy modeling/energy analysis



lighting technology

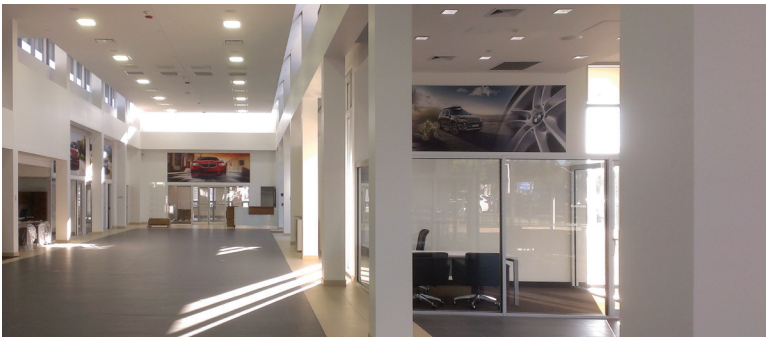

alterations



coastal design

H 2 M Corporate Headquarters
Melville, NY ☎ 631.756.8000 🌐 h2m.com

f in @ 🐦 📌

New York
Albany | New York City | Riverhead | Suffern | Westchester

New Jersey
Central Jersey | Parsippany